

Technical data sheet

Wall connection set, double-sided, for corner mounting,
duct height 80 mm, FS
Item number: 7218138



Wall connection collar, 2-sided, with integrated seal for PYROLINE® Rapid PLM installation duct. For mounting in the area of wall and ceiling connections as well as wall penetrations in room corners. Set consisting of 2 opposing components, suitable for ceiling or wall mounting of the installation duct.



- St** Steel
- FS** Strip galvanized

Master data

Item number	7218138
Type	PLM CC 0810 FS
Description 1	Wall connection collar set
Description 2	for corner mounting
Manufacturer	OBO
Dimension	85x175x157
Material	Steel
Surface	Strip galvanized
Surface standard	DIN EN 10346
Smallest sales unit	1
Unit of quantity	Piece
Weight	49.78 kg
Weight unit	kg/100 pc.

Technical data sheet

Wall connection set, double-sided, for corner mounting,
duct height 80 mm, FS
Item number: 7218138



Dimensions

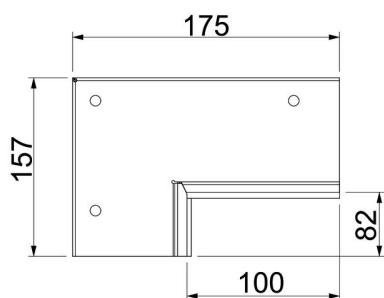
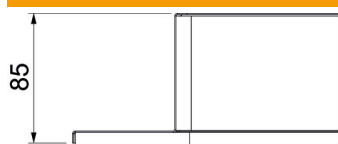

Dimension B	175 mm
Dimension b	100 mm
Dimension d	82 mm
Dimension H	157 mm

Technical data

Type of accessory	Wall connection collar
Accessories	yes
Spare part	no