

Technical data sheet

Zinc-nickel coated steel sleeve, with thread

Item number: 2046556



Accessory part: coupling with thread according to EN 60423 to connect electrical installation pipes and 90° bends.



St Steel

DN Zinc / nickel coated

Master data

Item number	2046556
Type	SVM25W DN
Description 1	Conduit threaded coupler
Description 2	with thread
Manufacturer	OBO
Dimension	M25x1,5
Material	Steel
Surface	Zinc / nickel coated
Surface standard	
Smallest sales unit	50
Unit of quantity	Piece
Weight	3.986 kg
Weight unit	kg/100 pc.

Technical data sheet

Zinc-nickel coated steel sleeve, with thread

Item number: 2046556



Dimensions

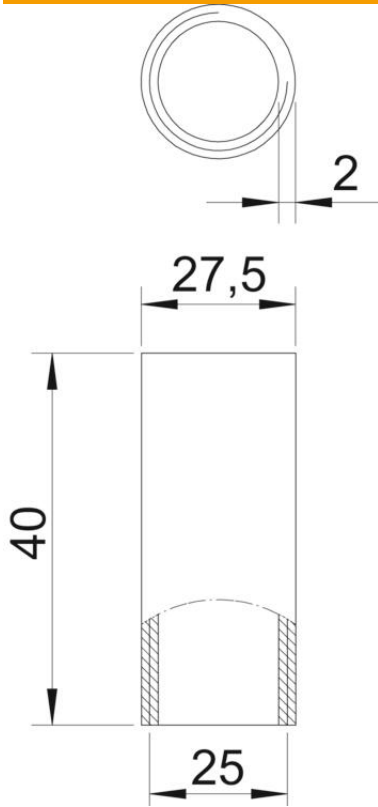

Length	40 mm
Dimension D	27.5 mm
Dimension d	25 mm
Dimension L	40 mm
Dimension m (mm)	M25
Dimension t	2 mm

Technical data

Version for for pipe diameter	Thread 25 mm
Thread	M25x1,5
Size	25
Halogen-free	no
With inspection opening and lid	no
Brushed surface	no
Polished surface	no
Permitted temperature range, max.	400 °C
Permitted temperature range, min.	-45 °C
Two-part	no